

M^r B. M^r Nicholson claims the whole of the land included within the black lines on his first four Warrants above mentioned, and also that space between the same and the Red line part of his other two Warrants.

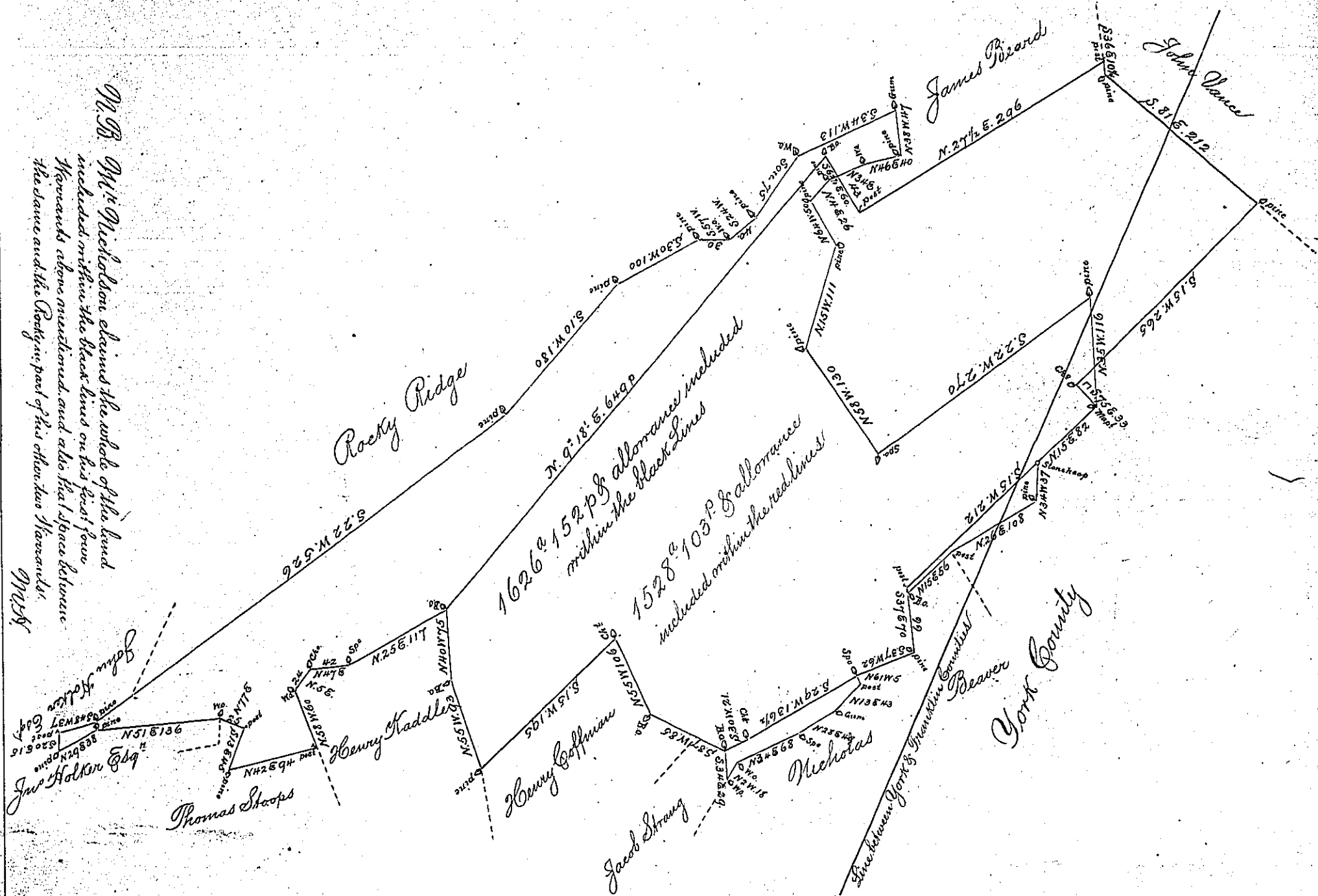

The above Draft describes a Parcel of Land Situate in Guilford and Green Townships in the County of Franklin. The black lines represent a Survey begun & carried on the 20th June 1793 for Samuel Nicholson Esq^r in execution of his Warrants in the Names of Matthew Duncan, Eliza Duncan, Sarah Nicholson, John Cooper, William Duncan & William Moulder, dated 3^d January 1793. The Circumstances intervening which prevented the completion of the Surveys at that time were --- that Henry Kaddler had an Improvement and Warrant adjoining the Land intended to have been taken in, it was thought proper that Kaddler's Survey should first be made, and had weather coming on at the same time the Business was postponed until the 3^d April 1794 when a Survey was made for Henry Kaddler, and on the 7th of the same Month, at the Instance of John Colker Esq^r who also claims the greater part of the same Lands under part of twenty seven Warrants dated 6th Sept^r 1792 beginning with Robert Smith & ending with Alex^r J. Dallas the lines formerly run were revised and new ones run, represented above with red Ink. The Surveys previously made for M^r Colker and the intermediate Vacancies and Matters relative thereto are all represented in a general Draft accompanying this for the inspection of the Board of Property, & humbly submitted by

To Daniel Brodhead Esq^r
Surveyor General of Pennsylvania

Matthew Moulder, S. J.
15th Jan^y 1795.

IN TESTIMONY that the above is a copy of the original remaining on file in the Department of Internal Affairs of Pennsylvania, made conformably to an Act of Assembly approved the 16th day of February, 1838, I have hereunto set my Hand and caused the Seal of said Department to be affixed at Harrisburg, this

first day of September 1903.
George D. Benson
Secretary of Internal Affairs.